

**Double Glazed**

Glazing Space = 1-1/4"  
 Minus Back Vynal - 1/8"  
  
 Minus Face Vynal - 1/8"  
 Equals Over All  
 Glass Thickness = 1"-

Note: Units CAN NOT Be Over 1" If Unsure  
 Smaller Is Better

**Single Glazed Glazing**

Space = 1/2"  
 Minus Back Vynal -1/8"  
 Minus Face Vynal -1/8"  
 Glass Thickness = \_\_\_\_\_

**Face Rubber**

(Small) 8515 = .090  
 (Standard) 8520 = .110  
 (Medium) 8530 = .130  
 (Heavy) 8540 = .164  
 (Ex Heavy) 8550 = .220

Note: This is to be used as a guide line Only  
 Due To Extruding Tolerances ,  
 Paint Thickness ,  
 Etching (thinning) During Anodizing  
 This space Can Vary  
 A mockup (sample) Should Be Test Each Time

DLO = Daylight Opening

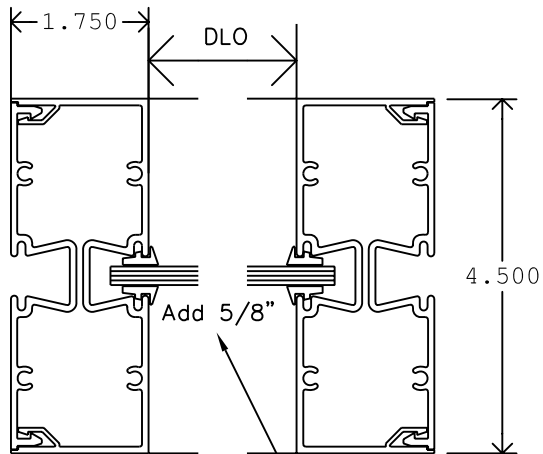

4500

Glass Size Add To Day-light Opening Size

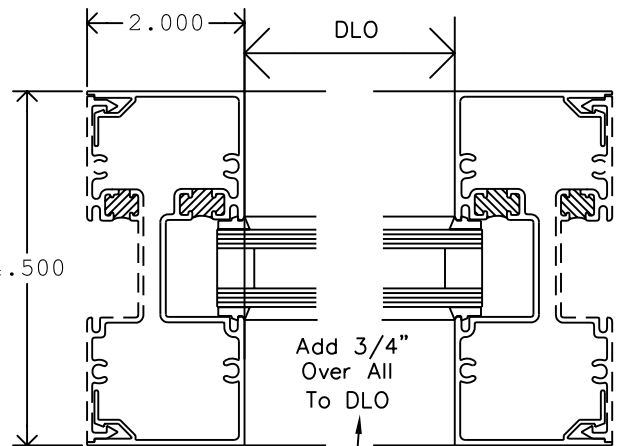

1140

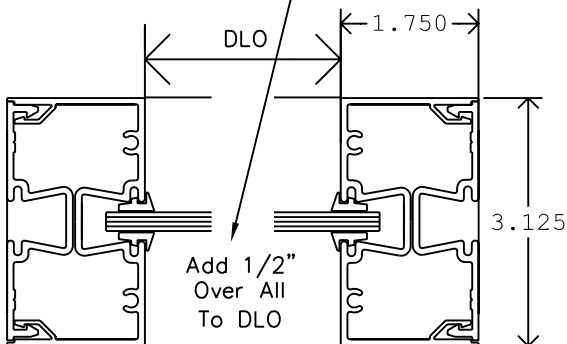

3000

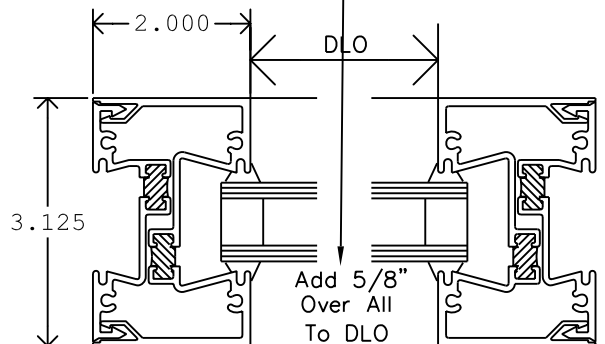

3020